

January 7<sup>th</sup>, 2013

NISSEI CORPORATION  
Sales Director M. Tomita

## Discontinuation Notice

To all of our dearest customers,

Thank you for your continued patronage.

The purpose for this communication is to inform you of the discontinuation of the products described below.

Though we will provide substitute models, we will also provide after service to the best of our abilities.

If you have questions or concerns regarding this discontinuation please feel free to contact the GTR representative of your area.

### — Notes —

#### 1 . Affected Models

■ GTR MID SERIES F2 Series (Hollow/Solid shaft)

- Standard : Without brake / With brake
- IP65 (water proof) : Without brake / With brake
- Reducer (No motor • Two-side shaft)、S type reducer (Third-party motor compatible model)

■ GTR A Series AF2 Types (Concentric hollow/solid shaft)、AF Type (Hollow/Solid shaft)

- High-precision reducers for servo motors.

■ Battery powered VF2 type (Concentric hollow / solid shaft)

- Without brake / With brake

#### 2 . Discontinuation date

End of July, 2013

#### 3 . Substitute models

Discontinued product	Substitute model
GTR MID SERIES F2 series (Concentric hollow／solid shaft)	GTR MID SERIES F3 series (Concentric hollow／solid shaft)
GTR A Series AF2 Type (Concentric hollow／solid shaft) AF Type (Hollow／solid shaft)	GTR A series AF3 type (Concentric hollow／solid shaft)
Battery Powered VF2 type (Concentric hollow／solid shaft)	Battery Powered VF3 series (Concentric hollow／solid shaft)

#### 4 . Replacement orders available up until

July, 2020. (7 years)

# Differences between F3 Series and F2 Series

Although the mounting dimension is the same between F2 Series and F3 Series with the reduction ratio of 1/5~1/60, the length of the hollow shaft is different. Also, the width of the casing will be different in both hollow and solid shaft. Therefore, when replacing F2 Series to F3 Series, be sure to confirm the dimensions shown below:

## F3 Series

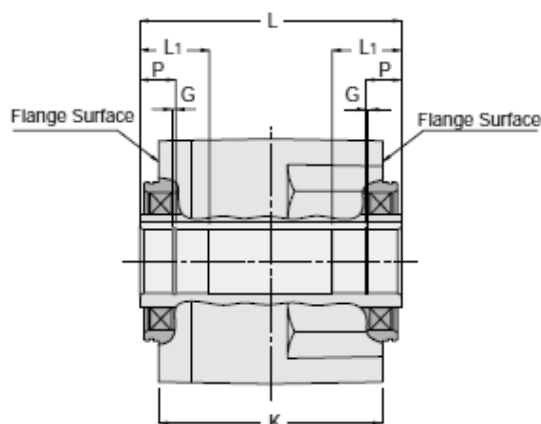

## F2 Series

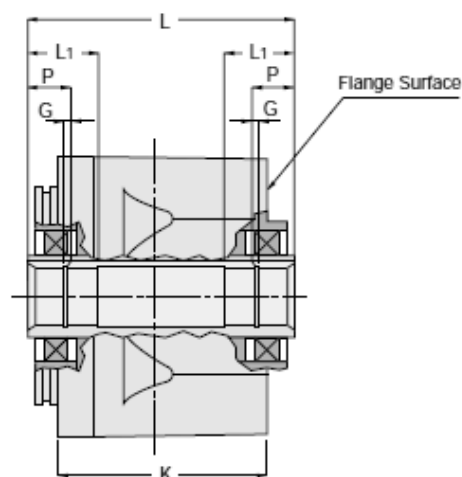

Frame Number	L		L <sub>1</sub>	P	G
	F3 Series	F2 Series			
20	96	91	24	13	1.15
25	118	108	27	14	1.35
30	124	117	33	17	1.35
35	142	124	38	20	1.75
45	168	140	50	26	1.95

\* The dimensions of L<sub>1</sub>, P and G are the same between F2 Series and F3 Series.

Frame Number	K	
	F3 Series	F2 Series
20 (18)	78	71.5
25 (22)	100	83.5
30 (28)	106	93.5
35 (32)	124	102.5
45 (40)	150	118.5

Frame number 50 and 55 are not available in F2 Series.

\* Common to F3S Type and F3F Type. The values in the parenthesis in the "Frame Number" are that for F3F.

# Differences between the AF3 Type and AF2 Type

Although the mounting procedures are the same for the AF3 and AF2 types with hollow shaft for reduction ratios from 1/5 through 1/60, the length of the hollow shaft is different. Also, because the width of the casing is different for hollow shaft and solid shaft, when replacing an AF2 type with an AF3 type please check the dimensions below.

## Backlash Precision 1 Arcmin, 3 Arcmin Specs

AF3 Type

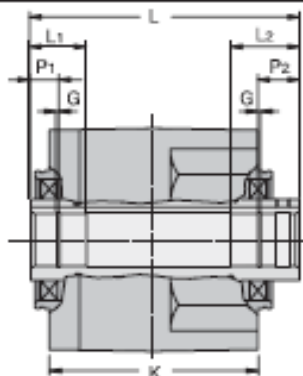

AF2 Type

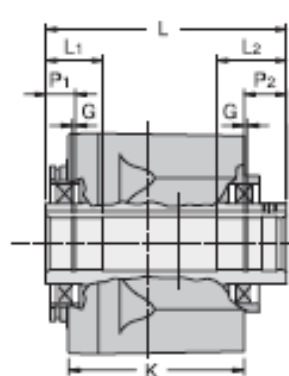

Frame Number	L		L1	L2	P1	P2	G
	AF3 Type	AF2 Type					
25	129	114	27	33	14	20	1,35
30	135	124	33	40	17	23	1,35
35	153	133	38	47	20	26	1,75
45	183	153	50	63	26	39	1,95

(Note) 1. L1, L2, P1, P2, G are the same dimensions.

2. Frame number 15 (100W equiv.) does not differ in dimensions.

Frame Number	K	
	AF3 Type	AF2 Type
25 (22)	100	83,5
30 (28)	106	93,5
35 (32)	124	102,5
45 (40)	150	118,5

(Note) 1. Compatible with both hollow shaft and solid shaft.

2. Frame numbers in parentheses are solid shaft values.

## Low Backlash Spe

AF3 Type

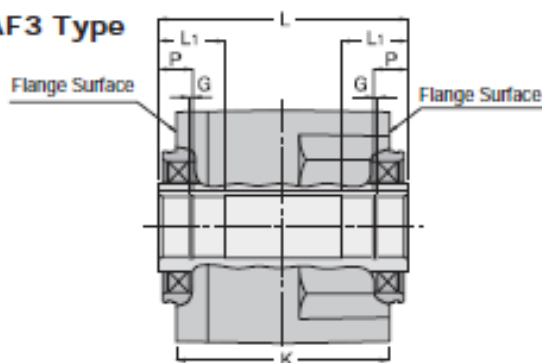

AF2 Type

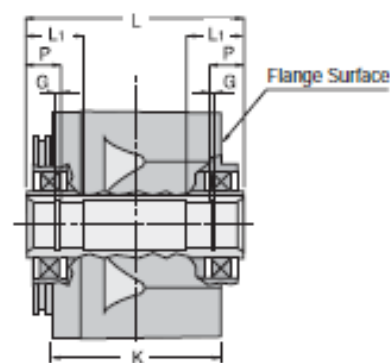

Frame Number	L		L1	P	G
	AF3 Type	AF2 Type			
20	96	91	24	13	1,15
25	118	108	27	14	1,35
30	124	117	33	17	1,35
35	142	124	38	20	1,75
45	168	140	50	26	1,95

(Note) 1. L1, P, G are the same dimensions.

Frame Number	K	
	AF3 Type	AF2 Type
20 (18)	78	71,5
25 (22)	100	83,5
30 (28)	106	93,5
35 (32)	124	102,5
45 (40)	150	118,5

(Note) 1. Compatible with both hollow shaft and solid shaft.

2. Frame numbers in parentheses are solid shaft values.

# Differences Between VF3 and VF2

■ VF3 is the successor to VF2. As a result, fitting it with reduction rates of 1/5 to 1/60 works the same way, but the length of the hollow shaft (output shaft) differs. In addition, both hollow and solid shafts have differing case widths, so you should refer to the dimensions provided below when replacing the VF2 with the VF3. When the output shaft direction of rotation is connected as on p. E16, the VF3 will rotate clockwise, while the VF2 will turn counterclockwise, so be aware of the difference in rotational direction.

## VF3-Type

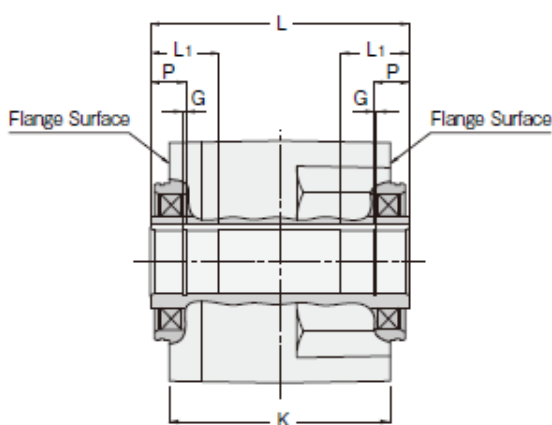

## VF2-Type

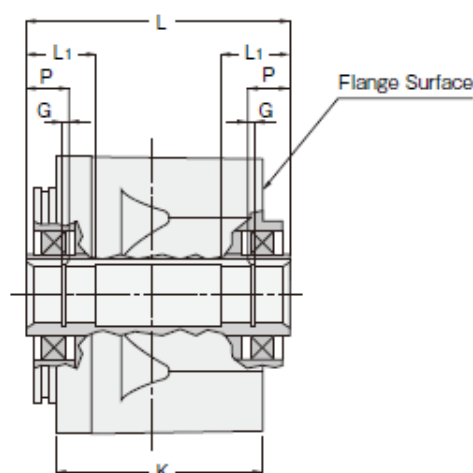

Frame No.	L		L <sub>1</sub>	P	G
	F3 Series	F2 Series			
25	118	108	27	14	1.35
30	124	117	33	17	1.35
35	142	124	38	20	1.75

Note: L<sub>1</sub>, P and G are the same dimensions.

Frame No.	K	
	F3 Series	F2 Series
25(22)	100	83.5
30(28)	106	93.5
35(32)	124	102.5

Note: This table applies to both F3S and F3F.  
The values given in parentheses are for F3F.

Contact information

NISSEI CORPORATION

• Overseas Sales Section: +81-566-92-5312

E-Mail [oversea@nissei-gtr.co.jp](mailto:oversea@nissei-gtr.co.jp)